



# FACADE LIGHTING



## FACADE LIGHTING

---

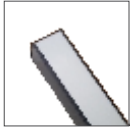

**FACADE**  
F501-F509



**LINEAR COVE LIGHT**  
L133/L134/L135



# FACADE





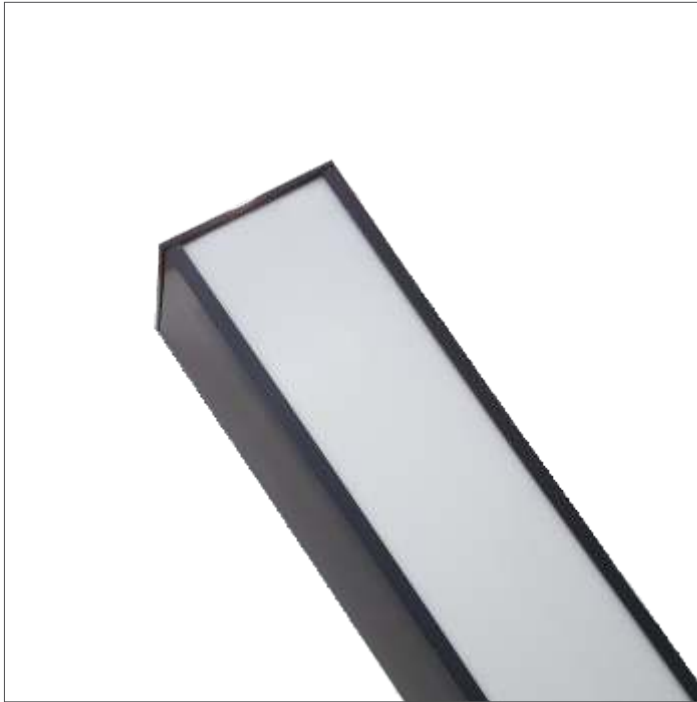

## MODEL NUMBER

FACADE 290 x 150  
 FACADE 150 x 150  
 FACADE 100 x 90  
 FACADE 70 x 95  
 FACADE 50 x 70  
 FACADE 40 x 25  
 FACADE 33 x 40  
 FACADE 27 x 27  
 FACADE 17 x 15  
 FACADE 17 x 8.5

## SPECIFICATIONS

**HOUSING** : LM 6 die cast aluminium and extruded aluminium.

**LIGHT SOURCE** : The fitting is designed to operate a range of LED's up to 10W/m.

**DIFFUSER** : PMMA.

**FINISH** : Powder coated.

**MOUNTING** : Surface mounted.

**CONTROL GEAR** : The electronic supply is suitable for operation with 220 – 240 volts - 50 hertz single phase.

**FASTENERS** : All external screws are stainless steel.

**INGRESS PROTECTION** : IP65.

**MECHANICS** : Operating Temperature (T<sub>a</sub>) - 20° C to +40° C.

**FEATURES** : Available in various sizes and lengths to allow for customised designs.

Remote power supply.

Cannot operate on a facade during the daylight, must be installed with a photocell.

1 - Power supply per 10m (2 x 5m). Max spacing per PSU.

## APPLICATION AREAS

Outdoor application.

Facade lighting.

Architectural lighting.

## COLOURS

	Black (BL)		Matt Silver (MS)
	White (WH)		Charcoal Grey (CG)





**DIMENSIONS IN MM**

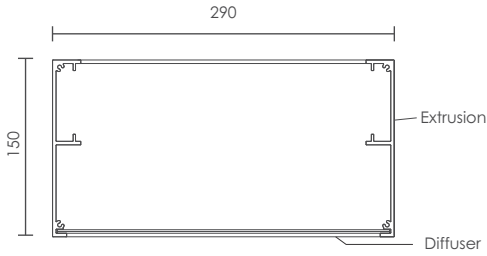

**FACADE 290 x 150**

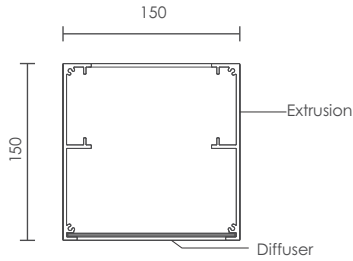

**FACADE 150 x 150**

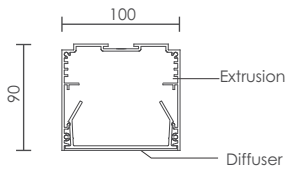

**FACADE 100 x 90**

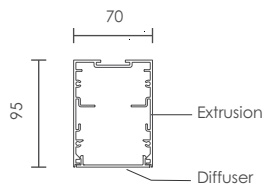

**FACADE 70 x 95**

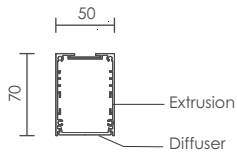

**FACADE 50 x 70**

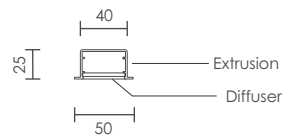

**FACADE 40 x 25**

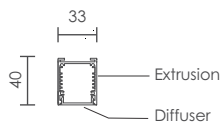

**FACADE 33 x 40**

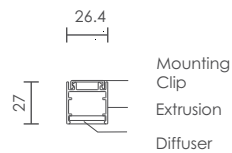

**FACADE 27 x 27**

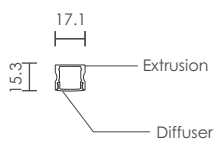

**FACADE 17 x 15**

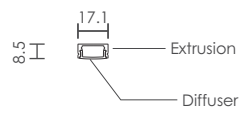

**FACADE 17 x 8.5**





**LIGHT SOURCE**

**LED STRIP**

Voltage	Type	Power (W/m)	Colour Temp	Nominal Flux (lm/W)
12V	Facade 290 x 150	10W / m	5000K 4000K 3000K	1710 lm / m
	Facade 150 x 150			
	Facade 100 x 90	5W / m		1062 lm / m
	Facade 67 x 101			
	Facade 50 x 70			
	Facade 33 x 40			
	Facade 27 x 27			
	Facade 16 x 16			







# LINEAR LED COVE

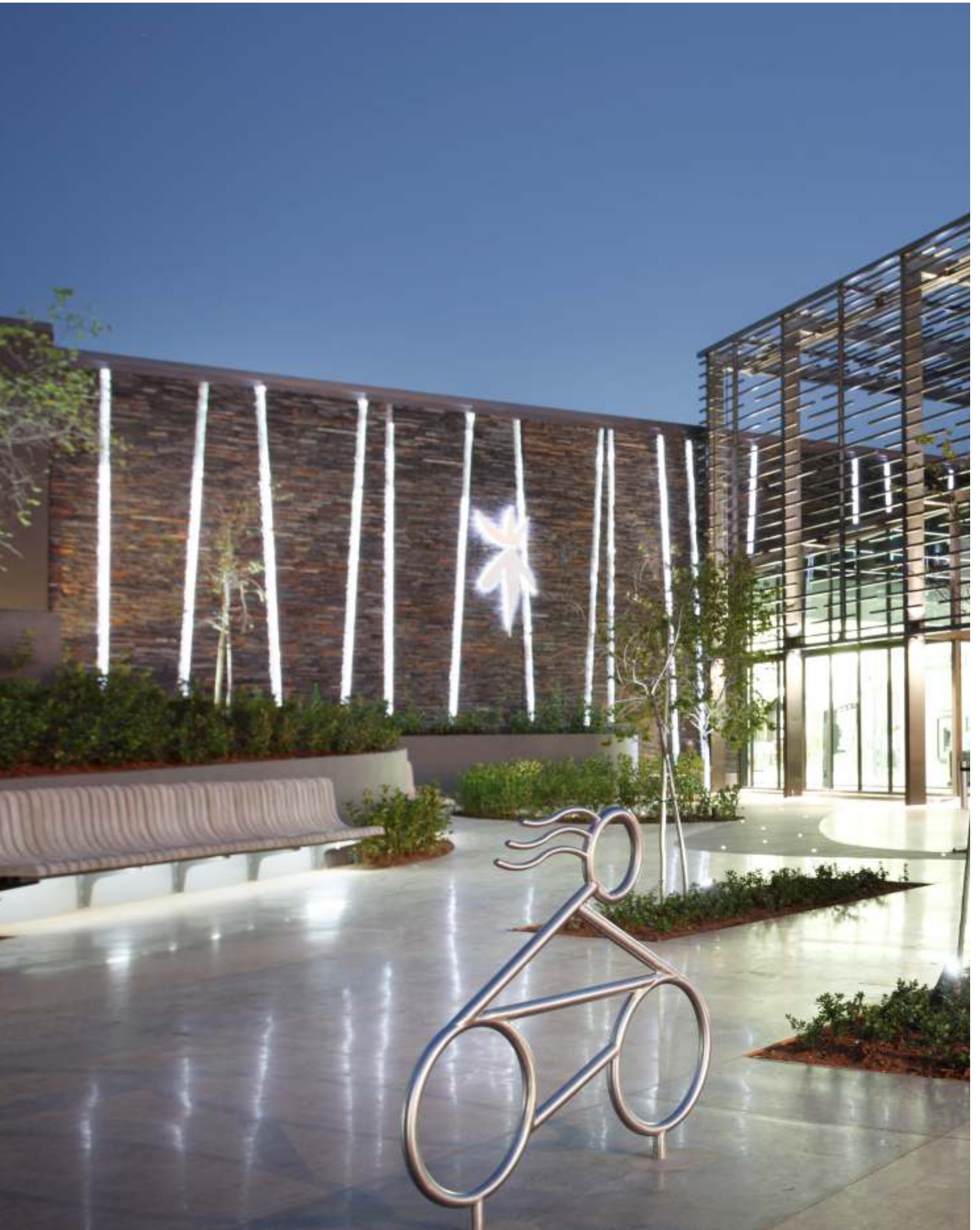



**MODEL NUMBER**

- L133 - LINEAR LED COVE 14
- L134 - LINEAR LED COVE 25
- L135 - LINEAR LED COVE 33

**SPECIFICATIONS**

**HOUSING** : Anodised aluminium extrusion.  
**LIGHT SOURCE** : Osram LED.  
**DIFFUSER** : Polycarbonate.  
**MOUNTING** : Standard Bracket or adjustable bracket for easy installation.  
**FEATURES** : Low power consumption.  
 Available colour temperature 4000K.  
 On board current control at 24V.  
 Various brightness levels.  
 Thermal management system to ensure long life and lumen maintenance.  
 Life time of L70 = 50 000hrs at  $t_a$  25° C.  
 Various LED spacing : 14mm, 25mm, 33mm.  
 Plug-in connectors between PSU/ strips available.

Long lengths per power supply to save on cost.

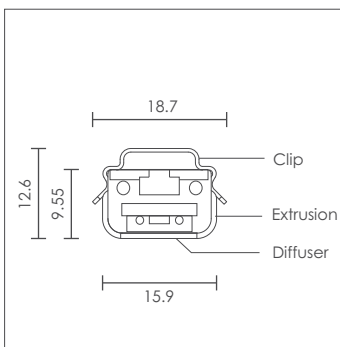

Section View Linear LED Cove

**APPLICATION AREAS**

- Outdoor application.
- Signage.
- Architectural lighting.
- Bulkhead lighting.
- Shop fitting.
- Cove lighting.







LIGHT SOURCE



LED COVE 14			
Strip Length (mm)	Wattage	Lumen	Max Linear Length
		4000K	
1486 mm	36.4W	4160 lm	2.5m
1192 mm	29.2W	3337 lm	
996 mm	24.4W	2788 lm	
800 mm	19.6W	2240 lm	
604 mm	14.8W	1691 lm	
408 mm	10.0W	1142 lm	
212 mm	5.2W	593 lm	



LED COVE 25			
Strip Length (mm)	Wattage	Lumen	Max Linear Length
		4000K	
1366 mm	4.4W	375 lm	15m
1216 mm	3.9W	340 lm	
1066 mm	3.4W	300 lm	
916 mm	2.9W	255 lm	
766 mm	2.5W	215 lm	
616 mm	2.0W	172 lm	
466 mm	1.5W	130 lm	
316 mm	1.0W	88 lm	
166 mm	0.5W	46 lm	



LED COVE 33			
Strip Length (mm)	Wattage	Lumen	Max Linear Length
		4000K	
1402 mm	17.0W	1680 lm	6m
1204 mm	14.6W	1440 lm	
1006 mm	12.2W	1205 lm	
808 mm	9.8W	970 lm	
610 mm	7.5W	740 lm	
412 mm	5.0W	494 lm	
214 mm	2.6W	255 lm	



**DIMENSIONS IN MM**

**LED COVE 14**

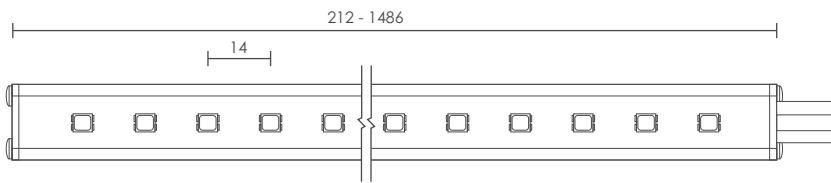

**LED COVE 25**

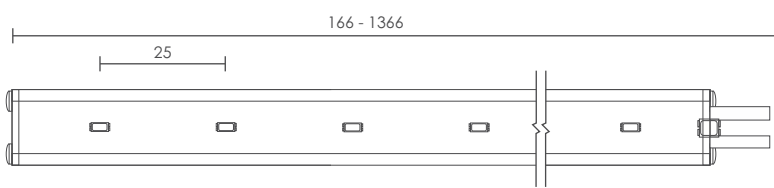

**LED COVE 33**

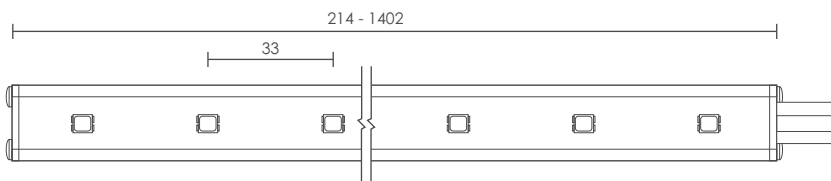

Adjustable Mounting Bracket

**LIGHT DISTRIBUTION**

LED Cove 14 - 4000K 212mm

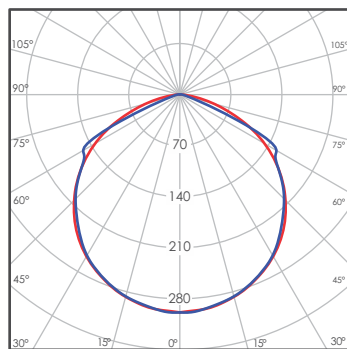

cd/klm  
— C0 - C180 — C90 - C270